

- NOTES:
- OCTANE P/N: 102632
 - TRACEABILITY: OCTANE S/N
 - ALL DIMENSIONS IN PARENTHESES () ARE REFERENCE ONLY.
 - PART MARKING: OCTANE MODEL NUMBER LABEL
 - FREQUENCY RANGE: 1400-5900 MHz
 - WEIGHT: 0.35 OZ

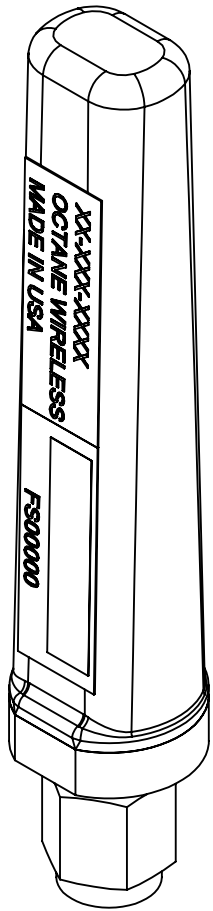

ISO VIEW

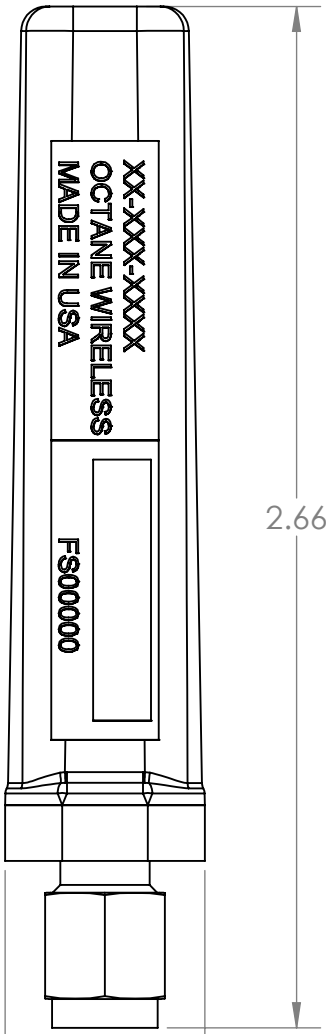

FRONT VIEW

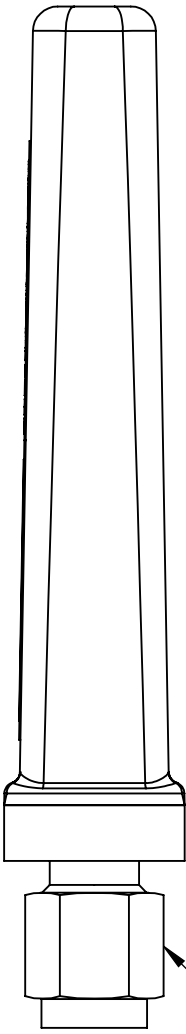

RIGHT VIEW

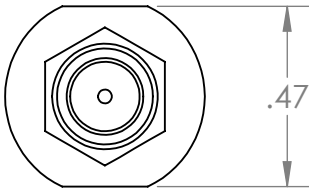

BOTTOM VIEW

REVISIONS				
ZONE	REV.	DESCRIPTION	DATE	APPROVED
N/A	A-01	DWG RELEASE	6/15/2016	MSF
N/A	B	DWG UPDATE	5/5/2021	CLQ

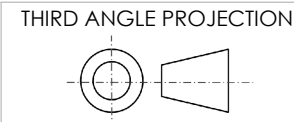

THIRD ANGLE PROJECTION

PROPRIETARY AND CONFIDENTIAL
THE INFORMATION CONTAINED IN THIS DRAWING IS THE SOLE PROPERTY OF OCTANE WIRELESS. ANY REPRODUCTION IN PART OR AS A WHOLE WITHOUT THE WRITTEN PERMISSION OF OCTANE WIRELESS IS PROHIBITED.

UNLESS OTHERWISE SPECIFIED:			
DIMENSIONS ARE IN INCHES			
TOLERANCES:			
TWO PLACE DECIMAL ±.010			
THREE PLACE DECIMAL ±.005			
ANGULAR ±1°			
MATERIAL		COMMENTS:	
SEE NOTES			
FINISH			
SEE NOTES			
DO NOT SCALE DRAWING			

OCTANE WIRELESS 1340 CHARWOOD ROAD, SUITE L HANOVER, MD 21076			
TITLE: ASSEMBLY, STUB ANTENNA 1400-5900 MHz, SMA MALE CONNECTOR			
SIZE C	DWG. NO. SA-1400-5900	REV B	
SHEET SCALE 2:1			SHEET 1 OF 1