

- NOTES:
1. PHARAD P/N 100554
  2. TRACEABILITY: PHARAD S/N
  3. PART MARKING: PHARAD LABEL 101108-003
  4. FREQUENCY OF OPERATION: 225 - 2500 MHz
  5. WEIGHT: 3 OZ

REVISIONS				
ZONE	REV.	DESCRIPTION	DATE	APPROVED
N/A	A	ENGINEERING PROTOTYPE	10/19/2010	JDM
N/A	A-01	REVISED POUCH LABEL TO INCLUDE S/N	2/21/2011	JDM

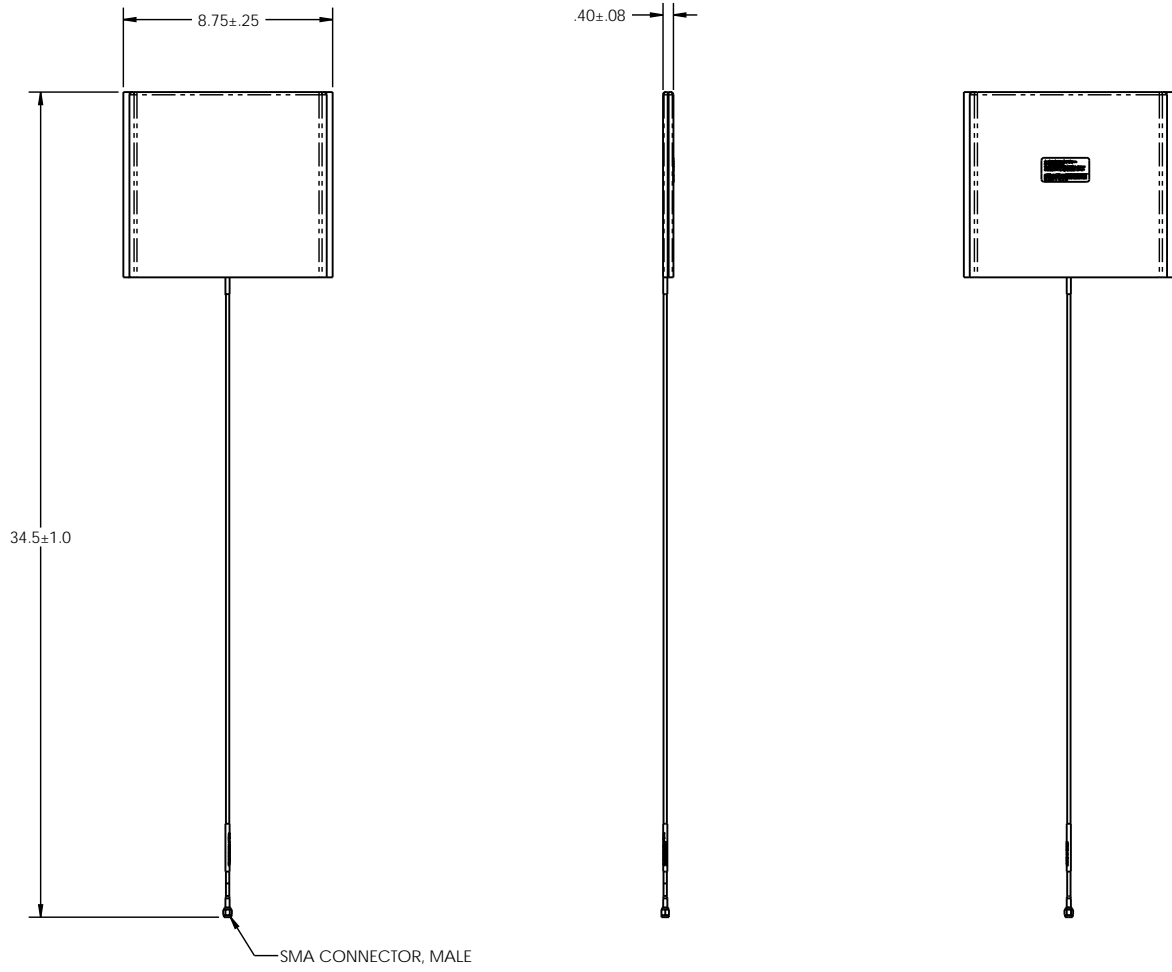

SMA CONNECTOR, MALE

**PROPRIETARY AND CONFIDENTIAL**  
 THE INFORMATION CONTAINED IN THIS DRAWING IS THE SOLE PROPERTY OF PHARAD, LLC. ANY REPRODUCTION IN PART OR AS A WHOLE WITHOUT THE WRITTEN PERMISSION OF PHARAD, LLC IS PROHIBITED.

UNLESS OTHERWISE SPECIFIED:			NAME		DATE		PHARAD, LLC 197 CROMWELL PARK DRIVE, SUITE V GLEN BURNIE, MD 21061	
DIMENSIONS ARE IN INCHES			DRAWN	JDM	10/19/2010		TITLE:	
TOLERANCES:			CHECKED				ASSEMBLY, WEARABLE ANTENNA, 225-2500 MHz	
TWO PLACE DECIMAL $\pm .010$			ENG APPR				SIZE DWG. NO.	
THREE PLACE DECIMAL $\pm .005$			MFG APPR				C BW-225-2500	
ANGULAR $\pm 1^\circ$			COMMENTS:				REV	
MATERIAL			SEE NOTES				A-01	
FINISH			SEE NOTES				SCALE: 1:4	
DO NOT SCALE DRAWING							SHEET 1 OF 1	